

COMPOSITE DECKING PROFILES

THE GOOD, THE BAD AND THE UGLY

Not all wood polymer composite decking is made the same; that's why we've created this guide to help you make an informed purchase decision. And if you'd like further advice, don't hesitate to contact us on 01469 535 415 or trex@arborforestproducts.co.uk.

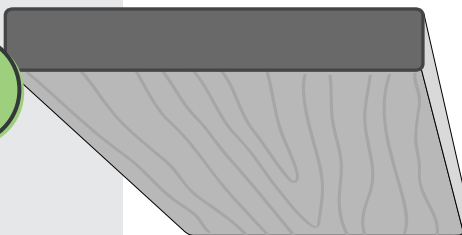

SOLID & CAPPED BOARD

Offering a guaranteed performance, these boards should come with a 25-year domestic and 10-year commercial warranty as standard.

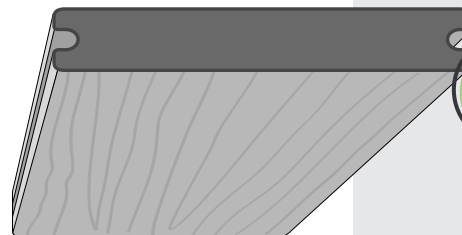

SOLID & CAPPED BOARD WITH GROOVE FOR HIDDEN FIXINGS

Featuring grooved edges to accommodate a hidden fixing system, these ensure improved performance against colour fade, stains, scratching and scuffing.

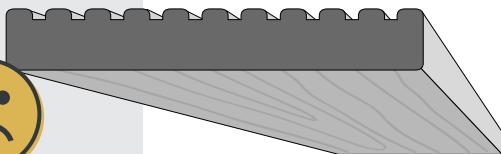

SOLID & UNCAPPED BOARD

These offer structural performance and integrity, but are liable to earlier fading - choose a trusted brand offering a product warranty.

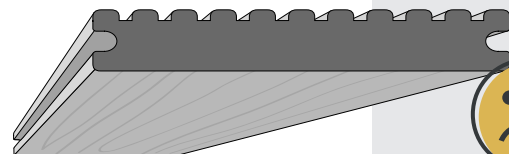

SOLID & UNCAPPED BOARD WITH GROOVE FOR HIDDEN FIXINGS

While offering strong structural performance, the deck's appearance will fade in the medium-term. A warranty and trusted supplier is essential.

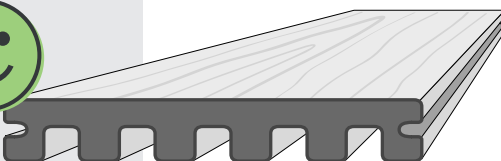

SCALLOPING & CAPPED

Providing a cost-effective solution, these boards should be purchased from a trusted brand which has undertaken performance testing and certification.

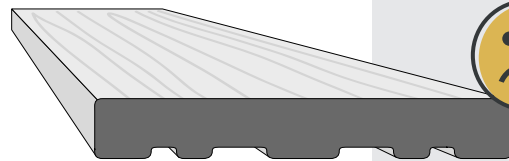

SCALLOPING & UNCAPPED

While product performance will be unaffected, these boards are subject to earlier colour fade. Always choose a trusted brand.

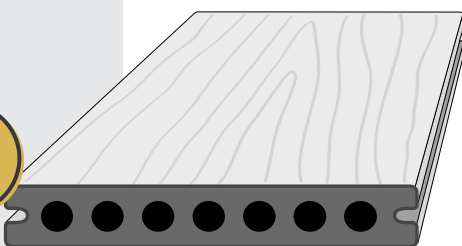

CIRCULAR HOLLOWCORE & CAPPED

Capped boards offer assured performance against colour fade and damage, but be careful - always check the manufacturer's product warranty.

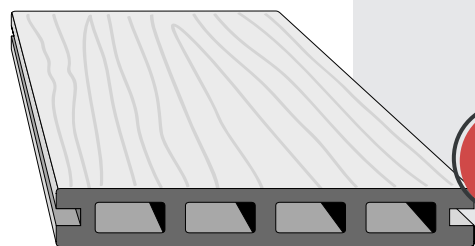

HOLLOWCORE /UNCAPPED

Don't be tempted by low prices - these are subject to structural failure and significant damage, with a short warranty period.